

ACTUATOR SHOWN AT MIDSTROKE

REVISION TABLE					
REV	ECN#	DESCRIPTION	REV BY	APPROVED	DATE
---	---	Pre-Release Drawing	JRM	MPW	7-12-17
A	1998	Added mtg. hole callout. Added tolerances.	SDC	MPW	7-14-17
B	2001	Changed design.	SDC	MPW	7-20-17
C	2008	Added lead wire & motion callouts	SDC	MPW	8-24-17

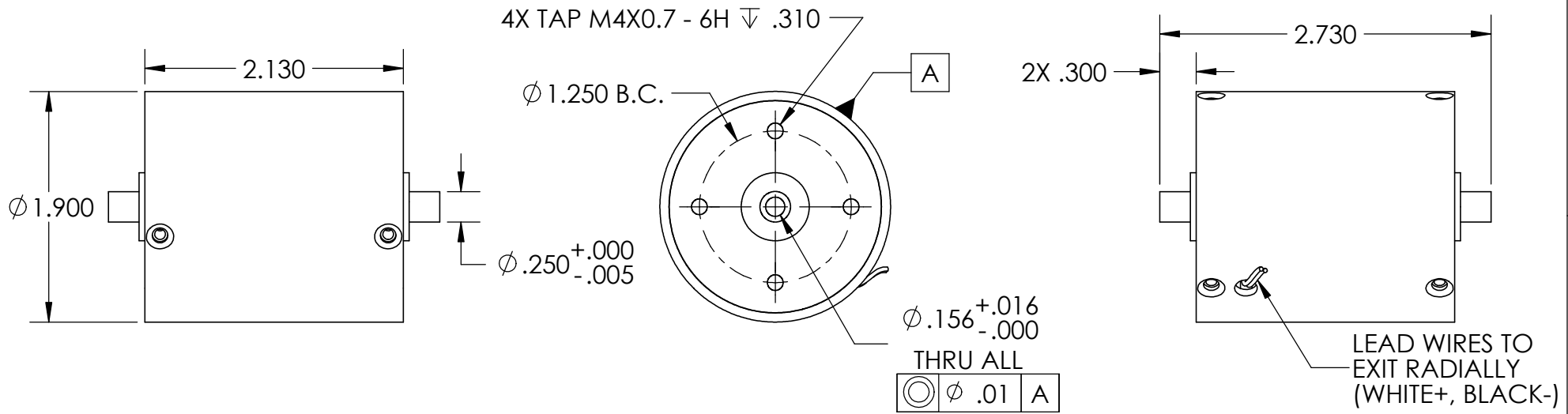

A

A

B

B

C

C

D

D



H2W Technologies, Inc.
 Santa Clarita, CA 91350 USA
 Tel: (661) 291-1620
www.h2wtech.com

These drawings and specifications are the property of H2W Technologies, Inc. They are issued in confidence and shall not be reproduced, copied, or used without written permission from H2W Technologies, Inc.

UNLESS SPECIFIED OTHERWISE:
 All dimensions are in inches
 Standard Tolerances are as follows
 .XXX ±.005 ANGLES ±.1°
 .XX ±.010 FILLETS .010
 .X ±.020 CORNERS .010
 Remove All Burrs and Sharp Edges

**FOR
 REFERENCE
 ONLY**

MATERIAL
 FINISH

TITLE
**Voice Coil Actuator Model #:
 NCM01-19-050-2I**

DWG # **30-1331**
 REV **C**
 DATE **8-24-17** SHEET **1 of 2**

1

2

3

4

5

NON-COMM ACTUATOR SPECIFICATIONS

Motor P/N	NCM01-19-050-2I	
Device Type	Moving Magnet	
Stroke	0.25 in	6.4 mm
Bearing Type	Sliding Contact	
Moving Mass	0.44 lbs	200 grams
Total Mass	0.92 lbs	417 grams
Resistance @ 20C	2.6 Ω	
Inductance @ 20C	0.7 mH	
Electrical Time Constant	0.3 msec	
Motor Constant	1.25 lbs/sqrt(watt)	5.56 N/sqrt(watt)
Force Constant	2.3 lbs/amp	10.2 N/amp
Back EMF	0.26 V/ips	10.2 V/m/s
Force @ 100% Duty	5.0 lbs	22.3 N
Power @ 100% Duty	16 watts	
Current @ 100% Duty	2.2 amps	
Force @ 10% Duty	15.0 lbs	66.8 N
Power @ 10% Duty	160 watts	
Current @ 10% Duty	6.5 amps	

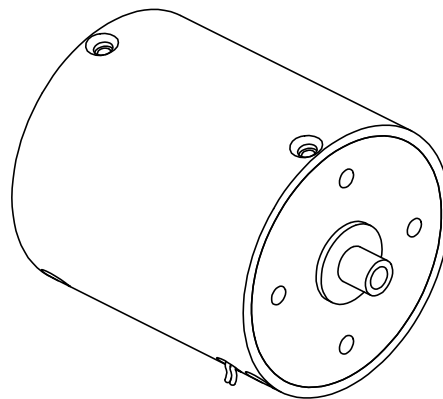

**H2W P/N#:
NCM01-19-050-2I**



H2W Technologies, Inc.
Santa Clarita, CA 91350 USA
Tel: (661) 291-1620
www.h2wtech.com

These drawings and specifications are the property of H2W Technologies, Inc. They are issued in confidence and shall not be reproduced, copied, or used without written permission from H2W Technologies, Inc.

UNLESS SPECIFIED OTHERWISE:
All dimensions are in inches
Standard Tolerances are as follows
.XXX \pm .005 ANGLES \pm .1°
.XX \pm .010 FILLETS .010
.X \pm .020 CORNERS .010
Remove All Burrs and Sharp Edges

**FOR
REFERENCE
ONLY**

MATERIAL

FINISH

TITLE

Voice Coil Actuator Model #:
NCM01-19-050-2I

DWG # **30-1331**

REV **C**

DATE **8-24-17**

SHEET **2 of 2**